

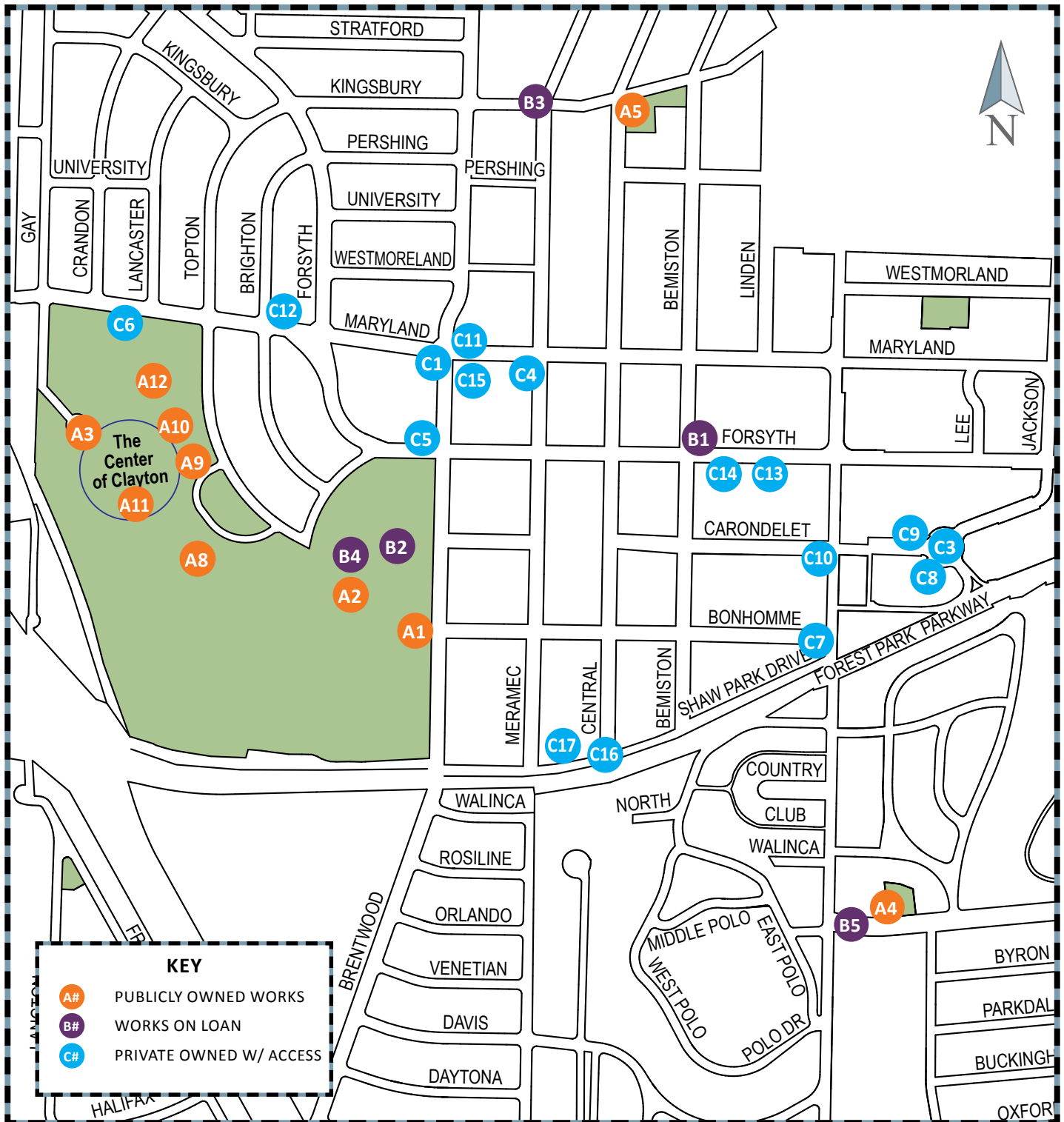



Public Art In our Midst





APPENDIX E

CLAYTON'S PUBLIC ART COLLECTION

PUBLICLY OWNED WORKS

A1  Title: "Molecular Bloom with Single Flower"
Artist: James Surls
Location: Shaw Park, Century Garden
Date: 2013
Medium: Stainless steel and bronze
Size: 19'h
Owner: City of Clayton, commissioned by the Clayton Century Foundation

A2  Title: "Egg"
Artist: Carol Flenning
Location: Shaw Park, Sensory Garden
Date: 2010
Medium: Ceramic
Size: 2' x 1.5' x 2.5'
Owner: City of Clayton, commissioned by the Clayton Century Foundation

A3  Title: "Uncertainty of Ground State Fluctuations"
Artist: Alice Aycock
Location: Center of Clayton, 50 Gay Avenue
Date: 2007
Medium: Aluminum, steel, and thermoformed plastic
Size: Unknown
Owner: City of Clayton, commissioned by the Clayton Art Commission

A4  Title: "Youth"
Artist: Todd Frahm
Location: Wydown Park
Date: 2002
Medium: Bedford limestone
Size: 5' x 4.5' x 4.5'
Owner: City of Clayton, commissioned by the Clayton Parks Foundation

A5  Title: Taylor Park Flagpole Base
Artist: Unknown
Location: Taylor Park
Date: 1977
Medium: Limestone and bronze
Size: 26" x 26" X 70"
Owner: City of Clayton

A8  Title: "Dancing Chairs"
Artist: Rod Baer
Location: Clayton School District Administration Building, Shaw Park
Date: 1998
Medium: Welded and painted steel
Size: 49' x 3' x 3'
Owner: City of Clayton, collaboration Clayton Art Commission, Arts in Transit, and Saint Louis Art Fair

A9



Title: "Globe"
Artist: Lester C. Heckle, Architect
Location: Clayton High School, #1 Mark Twain Circle
Date: 1953
Medium: Marble and granite
Size: 9' h x 7' w x 7' d
Owner: School District of Clayton

A10



Title: "Greyhound Pride"
Artist: Mike Pisoni
Location: Clayton High School, #1 Mark Twain Circle
Date: 2000
Medium: Cold cast aluminium, polyester resin mixed with aluminium dust, acrylic coating
Size: 8' h x 28' w
Owner: School District of Clayton, commissioned by CHS PTO for Principal Don Hugo's retirement

A11



Title: "Elizabeth"
Artist: Ruth Keller Schweiss
Location: Clayton High School, #1 Mark Twain Circle, in Quad
Date: 2000
Medium: Aluminium, epoxy
Size: 17' h
Owner: School District of Clayton, gift of Richard Baird in honor of his wife Phylis

A12



Title: "Primogenesis"
Artist: William Severson and Saunders Schultz
Location: Clayton High School
Date: 1981
Medium: Stainless steel
Size: 25' h x 25' w 20' d
Owner: School District of Clayton, gift from St. Louis Science Center in 2003

WORKS ON LOAN

B1



Title: "Folke Filbyter"
Artist: Carl Milles
Location: City Hall, 10 North Bemiston Avenue
Date: 1928
Medium: Bronze
Size: 12' x 8' x 5'
Owner: Saint Louis Art Museum - On Loan

B2



Title: "Geometric Abstract #2"
Artist: Ernest Trova
Location: Shaw Park, Moneta Garden
Date: 1978
Medium: Stainless Steel
Size: 5'h x 20"w x 5"d
Owner: St. Louis County - On Loan

B3



Title: "Two Standing Poets"
Artist: Ernest Trova
Location: Meramec and Kingsbury
Date: 1975
Medium: Painted Cor-ten steel
Size: 8'h x 8'w x 2'd
Owner: St. Louis County - On Loan

B4



Title: "One of Us on a Tricycle"
Artist: Steven Gregory
Location: Shaw Park, Tree Top Playground
Date: 2008
Medium: Bronze
Size: 500 x 230 x 350 cm
Owner: Gateway Foundation - On Loan

B5



Title: "Man on a Horse"
Artist: Fernando Botero
Location: Wydown and Hanley
Date: 1999, edition 1/3
Medium: Bronze
Size: 138" x 63" x 91"
Owner: Gateway Foundation - On Loan

PRIVATELY OWNED AND PUBLICLY ACCESSIBLE

C1



Title: "FM/6 Walking Jackman"
Artist: Ernest Trova
Location: Brentwood and Maryland Boulevards
Date: 1985
Medium: Stainless steel
Size: 9' 2" h x 15' w x 15' d
Owner: Philip Samuels Fine Arts

C3



Title: "Still Point"
Artist: Ruth Keller Schweiss
Location: Ritz Carlton Hotel, 100 Carondelet Plaza
Date: 1990
Medium: Bronze
Size: 12' x 20' x 12'
Owner: Clayton Land Company

C4



Title: "Les Danseuses"
Artist: William Severson and Saunders Schultz
Location: Mercantile Centre Plaza, 8000 Maryland Boulevard
Date: 1983
Medium: Stainless steel
Size: 18" x 20' x 10'
Owner: 8000 Maryland LLC, Principal Capital Land Management

C5



Title: "New Heights"
Artist: Jane DeDecker
Location: Forsyth and Brentwood Boulevards
Date: 2000
Medium: Bronze
Size: 17' h
Owner: Riggs and Co., division of Riggs Bank NA, as trustee of Multi-employer Property Trust

C6



Title: "Shoe of Shoes"
Artist: Victoria Fuller
Location: Caleres 5, 8300 Maryland Boulevard
Date: 1999
Medium: Aluminum
Size: 10' h x 18' w x 6' d
Owner: Leased from the artist by Caleres 5 (Brown Shoe Company)

C7



Title: "Windmill"
Artist: Edward Hebdricks
Location: Bonhomme and Hanley Roads
Date: 1989
Medium: Stainless steel
Owner: Gateway Frontier Properties

C8



Title: "Clayton Caryatid"
Artist: Howard Ben Tre
Location: 150 Carondelet Plaza
Date: 1989
Medium: Low expansion glass, bronze and polished granite
Size: 20" w x 115" h
Owner: THF Realty

C9



Title: "Uzumaki Curve"
Artist: Gerard Tsutakawa
Location: 155 Carondelet Plaza
Date: 2006
Medium: Bronze
Size: 13' x 9' x 6'
Owner: Mark Mehlman

C10



Title: "Spring Dance"
Artist: Dennis Smith
Location: South Hanley and Carondelet
Date: 1988
Medium: Bronze
Size: 5'8" x 3" x 3"
Owner: Paragon Group

C11



Title: "Wind Torchere"
Artist: Bill and Mary Buchen
Location: Brentwood and Maryland
Date: 2006
Medium: Unknown
Size: Unknown
Owner: Unknown

C12



Title: "Wings From Within"
Artist: Valerie Zavadil Walker
Location: 8229 Maryland Ave (Kelly Mitchell)
Date: 2008
Medium: Unknown
Size: 50" x 55"
Owner: Kelly Mitchell Group

C13



Title: "Glass Canopy"
Artist: Liam Gillick
Location: 7700 Forsyth Blvd. (Centene Plaza)
Date: 2010
Medium: Colored Glass with Vanceva® color interlayers
Size: N/A
Owner: Centene

C14



Title: "Wind Wall"
Artist: Ned Kahn
Location: 7700 Forsyth Blvd. (Centene Plaza)
Date: 2013
Medium: 93,000 individual aluminum flags or flappers
Size: 7 stories x 300'
Owner: Centene

C15



Title: "Andrew Carson Kinetic Sculptures" (4)
Artist: Andrew Carson
Location: Forsyth and Brentwood (Barry-Wehmiller)
Date: 2013-2014
Medium: Stainless steel and glass
Size: 8' and 12' tall
Owner: Barry-Wehmiller

C16



Title: "3 Grandfather Clock Columns" (3)
Artist: Carol Fleming
Location: Clayton MetroLink Station
Date: 2008
Medium: Ceramic
Size: 8'
Owner: Metro

C17



Title: "Oasis"
Artist: Catherine Woods
Location: Clayton MetroBus Station
Date: 2004
Medium: Painted, screened, and etched float glass panels & aluminum panels in coated steel frames
Size: 13'h x 4'3"w x 5"d (glass), 13'h x 3'w (aluminum)
Owner: Metro



A6 Title: "Deer Conversations"
 Artist: Catharine Magel
 Location: Oak Knoll Park
 Date: 2000
 Medium: Steel, wire mesh, foam, fiberglass, and paint
 Owner: City of Clayton, commissioned by Clayton Art Commission in collaboration with the Clayton Landscape Committee



A7 Title: "Handling the Bench"
 Artist: Carol Fleming and Walter Gunn
 Location: Oak Knoll Park - Uchitelle Garden
 Date: 2000
 Medium: Clay and mahogany
 Size: 4' h x 8' w
 Owner: City of Clayton, commissioned by the Clayton Art Commission in collaboration with the Clayton Landscape Committee



C2 Title: "Martin Luther"
 Artist: Ernest Rietschel
 Location: Concordia Seminary, 801 DeMun Avenue
 Date: 1903
 Medium: Bronze
 Size: 11' 6" x 5' x 5'
 Owner: Concordia Seminary